

How to make turn an ordinary manila folder into The Sparkle Box Lapbook:

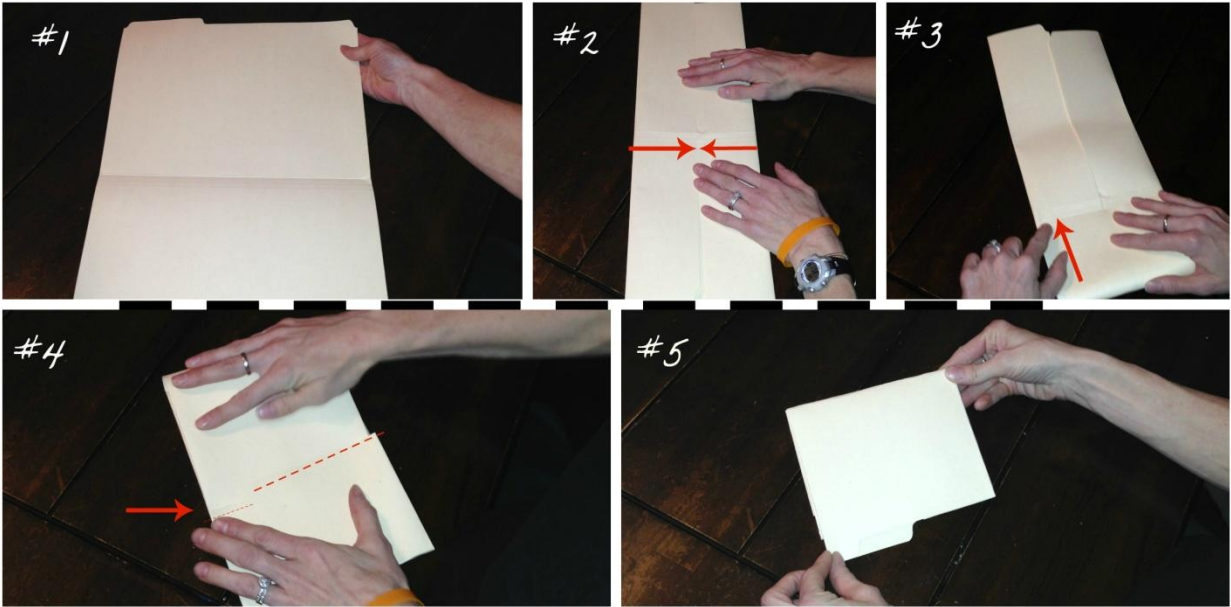

1. Open up the manila folder.
2. Fold in the left & right sides until they meet each other in the middle.
3. Fold the bottom up to the bottom of the 2nd line on the manila folder.
4. Fold the top tab down until it matches up with the bottom tab.
5. Now you are ready to let your child cut out the lapbook pieces and glue them into the lapbook.

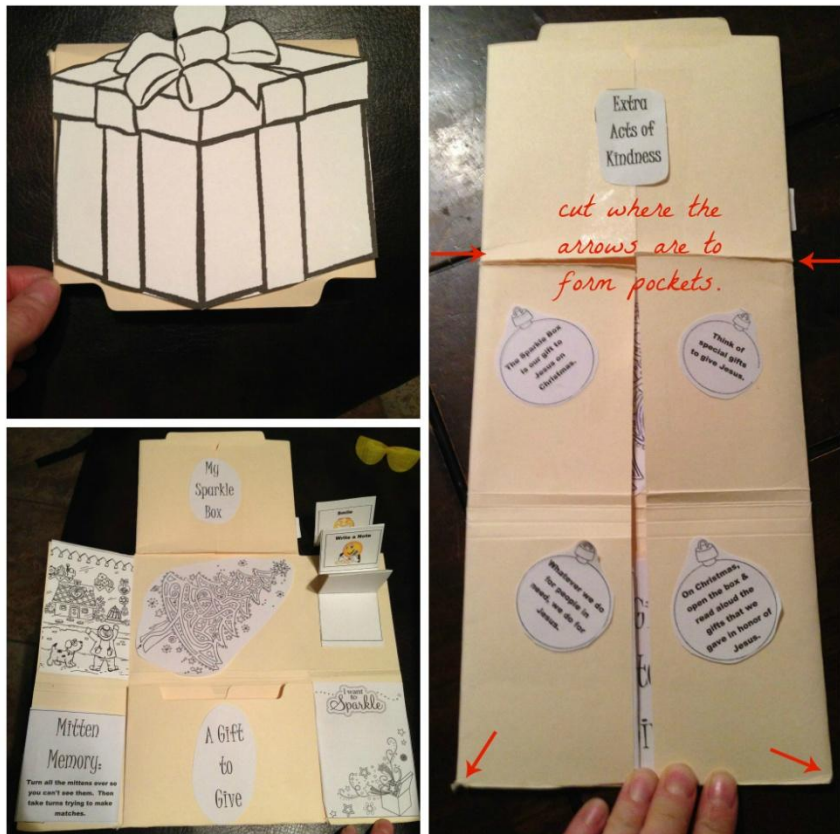

A GIFT
TO
GIVE

Extra
ACTS OF
Kindness

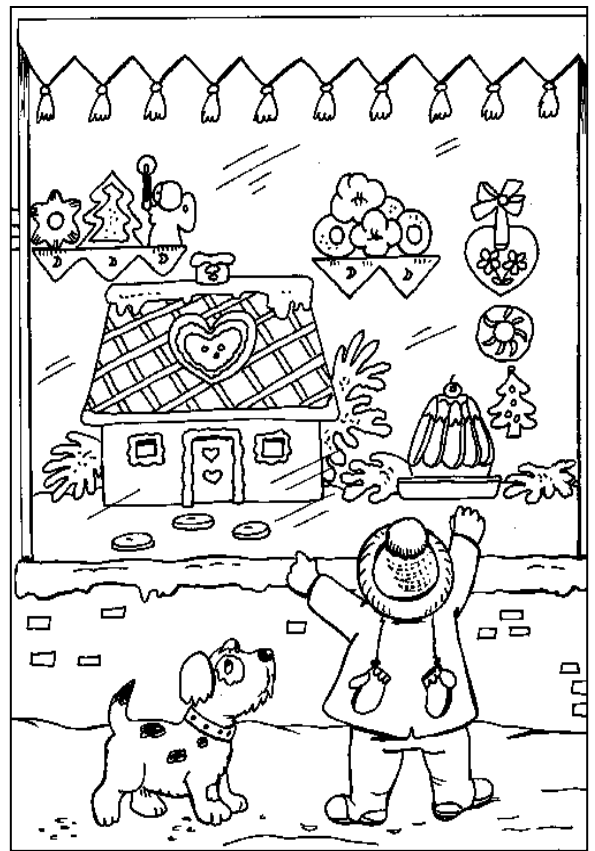
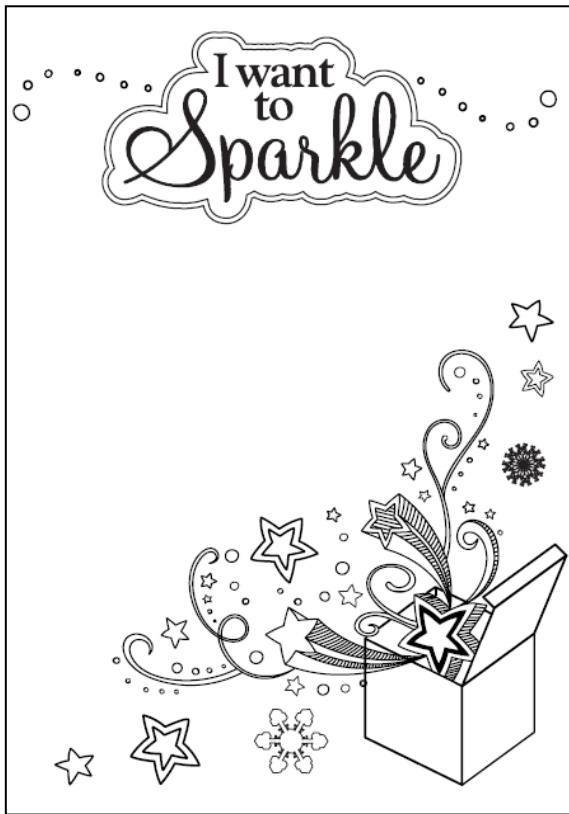

Write acts of kindness on slips of paper & pick on out each day. Find great ideas just by typing in "Random Acts of Kindness" in any search engine.

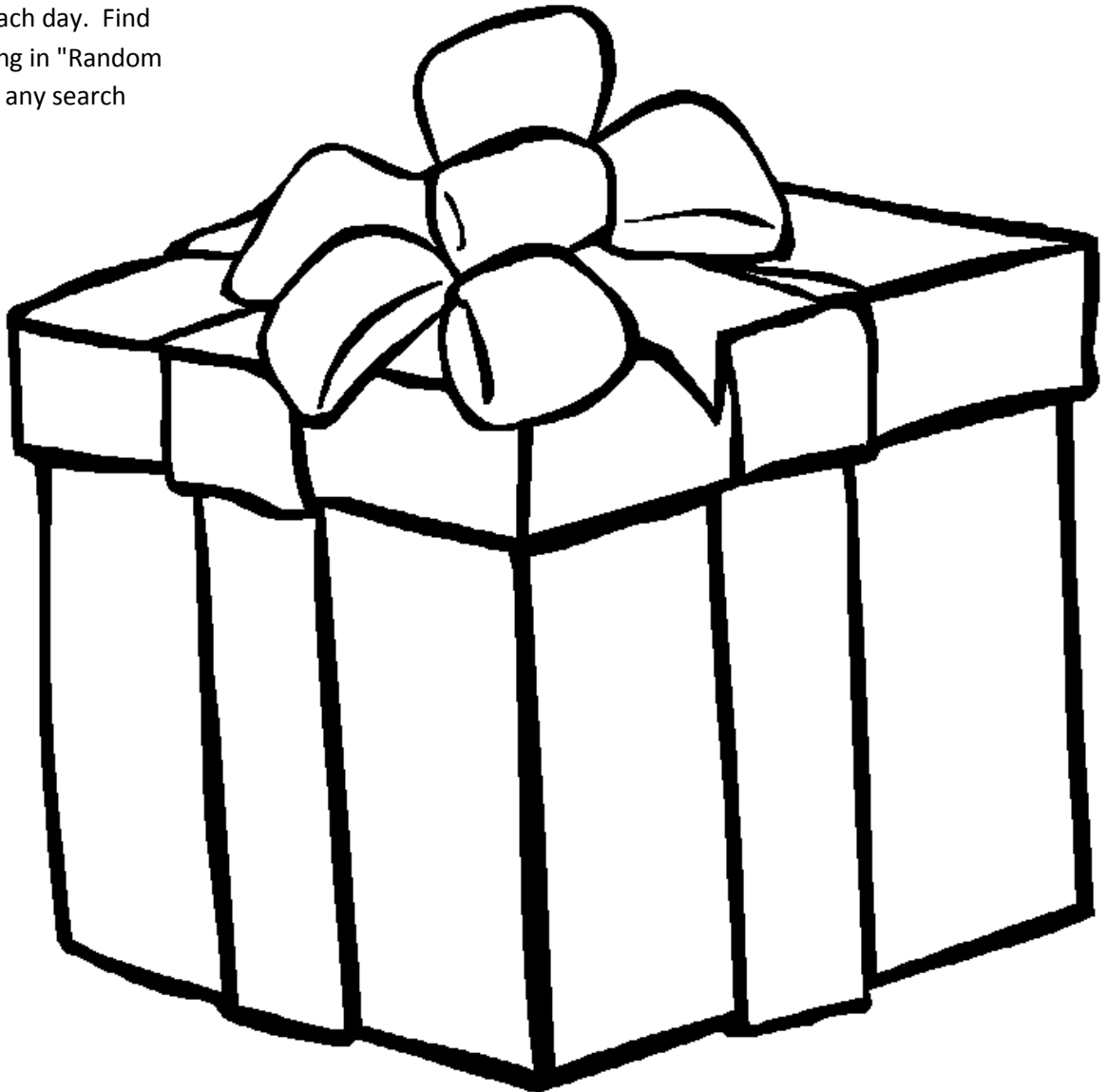

Fold along each of the lines to create an accordion.

Glue this square down to the folder.

Smile



Give a Hug



Help with a Chore



Share what I have



Pray for someone



Draw a picture



Write a Note



What can I do to fill up the Sparkle Box?

The Sparkle Box is our gift to Jesus on Christmas.

Think of special gifts to give Jesus.

Whatever we do for people in need, we do for Jesus.

On Christmas, open the box & read aloud the gifts that we gave in honor of Jesus.

#2 - Fold and glue to folder.

Mitten Memory

Game:

Color the each pair of mittens so they match. Turn all the mittens over so you can't see them. Then take turns trying to make matches.

#3 - Fold and glue to folder.

#1 - Fold then glue after all others have been folded.

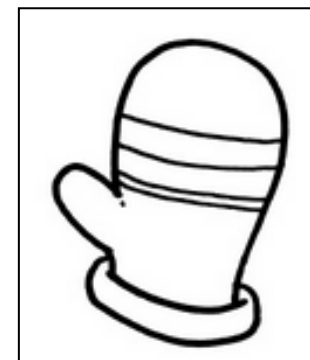
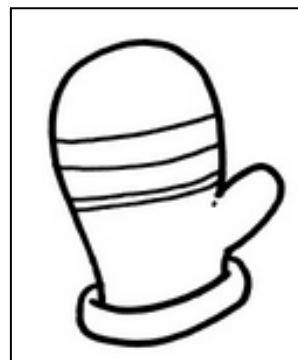
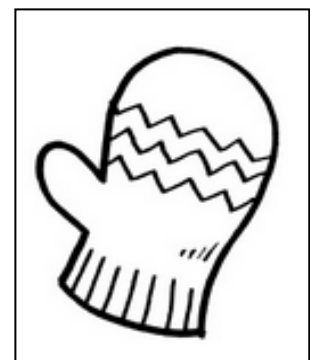
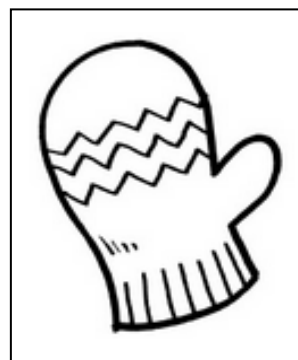
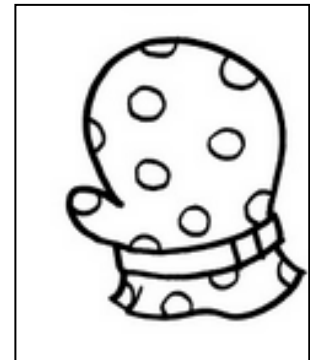
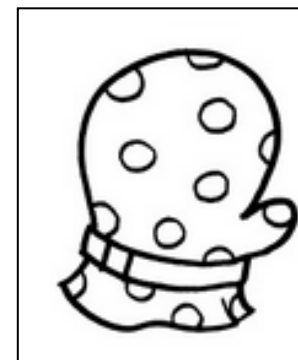
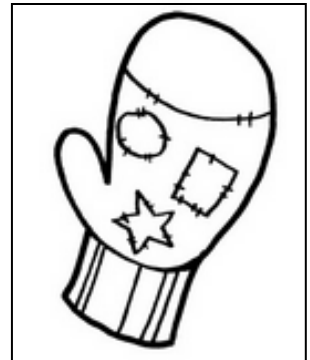
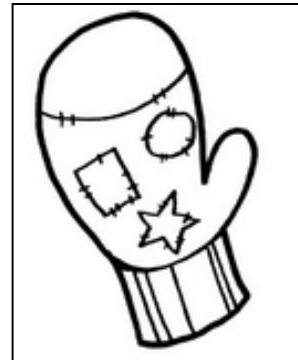
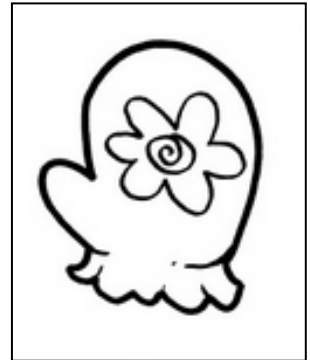
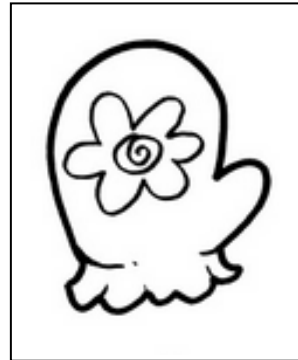

Christmas Tree Maze

Can you find your way from the base of the Christmas tree all the way to the star?

